

REVISIONS			
REV	DESCRIPTION	DATE	BY

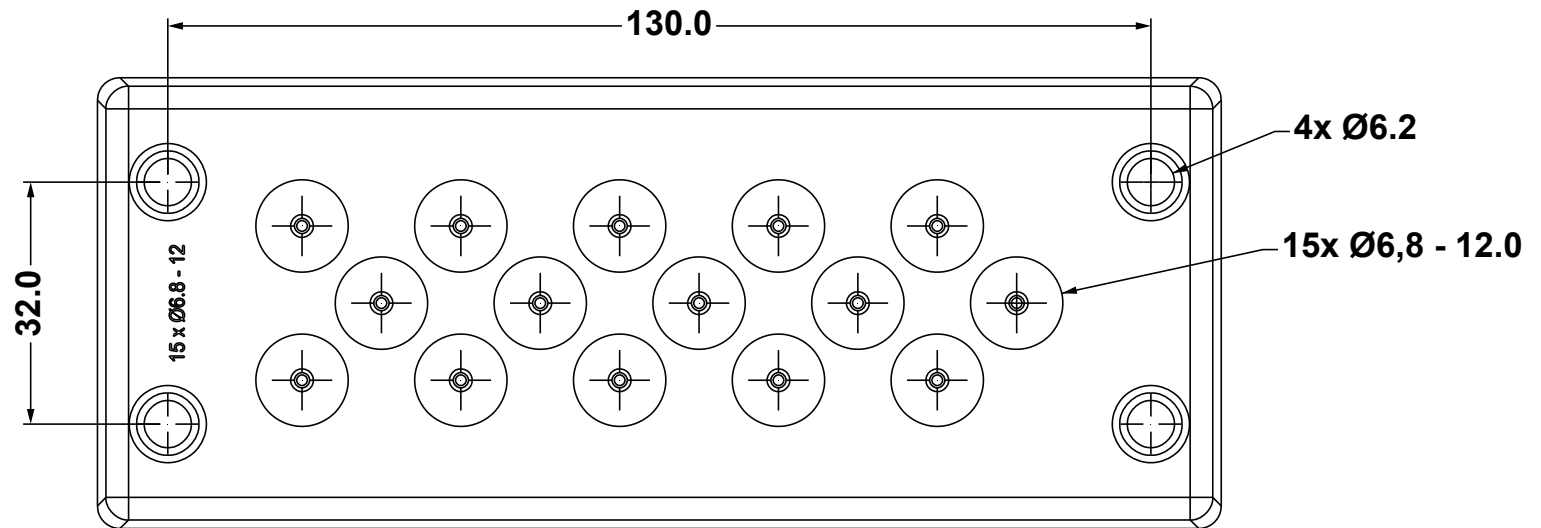

P/N COLOUR GREY	P/N COLOUR BLACK
16251PS11	16263PS01

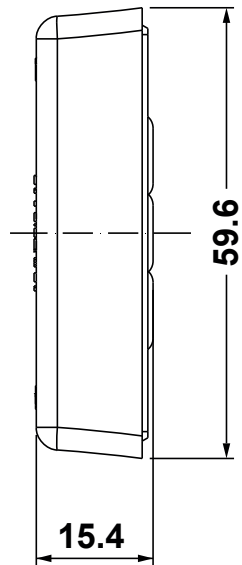
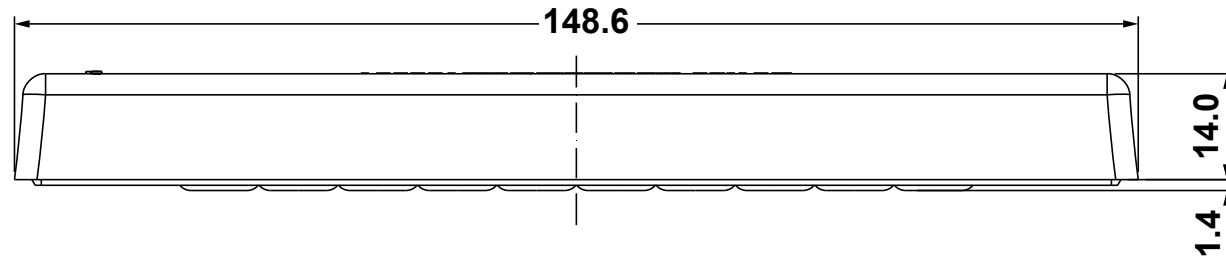
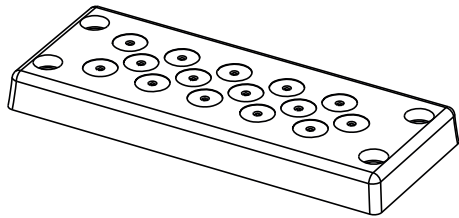

Flammability: UL94-V0, self-extinguishing
 Temperature: -40°C ... +105°C
 Properties: halogen-free, silicone-free

REV.	DESCRIPTION	DATE	TITLE: CABLE ENTRY PLATES WITH INTERNAL FRAME	DWG UNIT: MM
	MATERIAL: TPE/PA		Modelled in RHINO 4.0	FILE: DwN: 25/09/19
	COLOUR: SEE TABLE		TOLLERANCES UNLESS NOTED	ChkD: DT:19.09.25.162XX.0
			SHEET: 1 OF 1	Part Number: SEE TABLE
			SCALE: 1:1	

