

DIM.	TOL.
5mm DOWN	±0.2
5~20mm	±0.3
20~40mm	±0.4
40~60mm	±0.5
60~100mm	±0.8
100mm UP	±1.0

REVISIONS			
REV	DESCRIPTION	DATE	BY

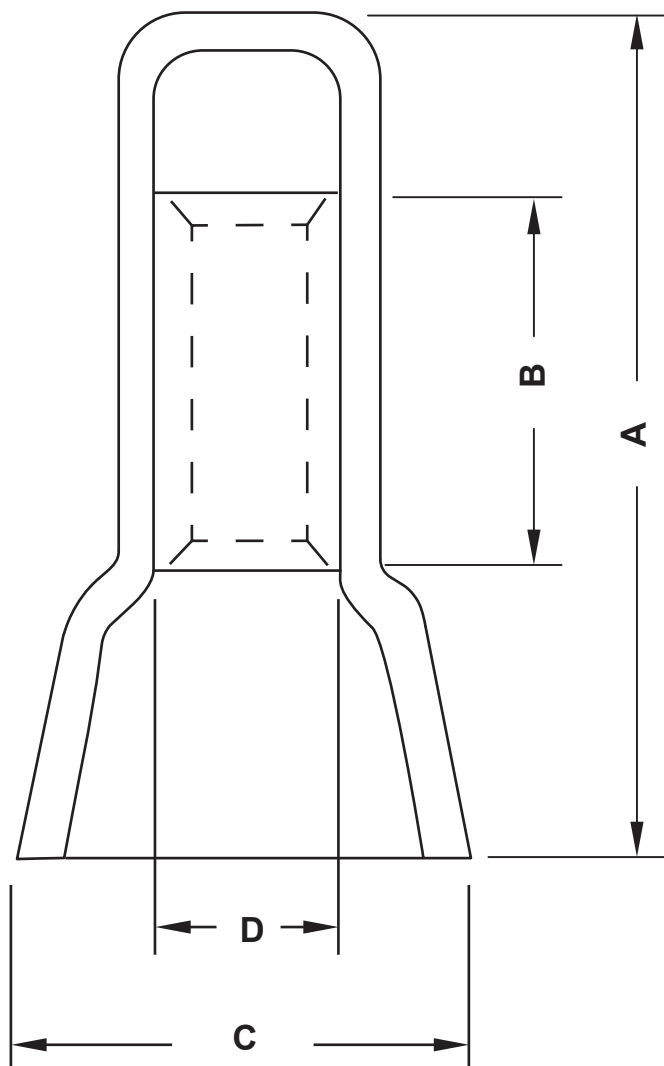

P/N	A	B	C	D
16568AA02	18,2	6,8	6,2	2,6
16569AA02	20,1	7,0	7,5	3,2
16570AA02	20,7	8,5	9,4	4,0

**MATERIAL:**

**TERMINAL MATERIAL: CU-ETP 99,9% TIN-PLATED COPPER**

**ISOLATION: PA 6.6 V2 UL94**

**NOMINAL TENSION: 300V MAX.  
MAX. WORKING TEMP.: 105°C**

				TITLE CLOSE-END CONNECTORS PA66	
				MATERIAL SEE ABOVE	
PART NUMBER SEE ABOVE				DRAWN A.C.	
				DRAWING NUMBER 22.05.30.165X.0.E	
SIZE A4		SCALE NTS		COLOR WHITE	
UNIT mm.		REV A		UNLESS OTHERWISE SPECIFIED TOLERANCE SEE ABOVE	
				APPROVED	