

Dimensions	Tolerance
5mm DOWN	±0.2
5~20mm	±0.3
20~40mm	±0.4
40~60mm	±0.5
60~100mm	±0.8
100mm UP	±1.0

REVISIONS			
REV	DESCRIPTION	DATE	BY



P/N	B	C	A	PACK/PCS
10083BB01	4,0	1,0	2,0 - 5,0	500
10084BB01	4,0	1,5	2,0 - 20,0	500
10085BB01	4,0	2,2	1,0 - 50,0	500
10086BB01	4,0	2,7	2,0 - 30,0	500
10087BB01	4,0	3,0	2,0 - 30,0	500
10088BB01	4,8	3,5	2,0 - 45,0	500
10089BB01	5,0	2,2	2,0 - 45,0	500
10090BB01	5,0	2,7	2,0 - 55,0	500
10091BB01	5,0	3,2	2,0 - 50,0	500
10092BB01	5,0	3,4	3,0 - 45,0	500
10093BB01	5,5	3,4	2,0 - 60,0	500
10094BB01	6,0	2,2	2,0 - 50,0	500
10095BB01	6,0	2,7	2,0 - 55,0	500
10096BB01	6,0	3,2	2,0 - 60,0	500
10097BB01	6,0	3,4	2,0 - 60,0	500
10098BB01	6,0	4,1	2,0 - 54,0	500
10099BB01	6,0	4,5	2,0 - 54,0	500
10100BB01	6,0	4,7	2,0 - 45,0	500
10101BB01	6,4	4,3	2,0 - 60,0	500
10102BB01	7,0	3,4	2,0 - 60,0	500
10103BB01	7,0	4,5	2,0 - 60,0	500
10104BB01	7,0	5,0	2,0 - 53,0	500
10105BB01	8,0	3,5	2,0 - 50,0	500
10106BB01	8,0	4,1	2,0 - 60,0	500
10107BB01	8,0	4,2	2,0 - 60,0	500
10108BB01	8,0	5,2	2,0 - 60,0	500
10109BB01	8,0	6,2	2,0 - 63,0	500

P/N	B	C	A	PACK/PCS
10110BB01	8,0	6,4	2,0 50,0	500
10111BB01	8,5	5,5	2,0 - 60,0	500
10112BB01	9,0	4,2	1,0 - 60,0	500
10113BB01	9,0	6,2	2,0 - 63,0	500
10114BB01	9,0	7,0	2,0 - 50,0	500
10115BB01	10,0	3,2	2,0 - 20,0	500
10116BB01	10,0	4,2	2,0 - 40,0	500
10117BB01	10,0	5,2	2,0 - 57,0	500
10118BB01	10,0	6,2	2,0 - 55,0	500
10119BB01	10,0	7,0	2,0 - 60,0	500
10120BB01	10,0	8,2	2,0 - 63,0	500
10121BB01	11,0	3,2	2,0 - 20,0	500
10122BB01	12,0	4,2	2,0 - 58,0	500
10123BB01	12,0	5,2	2,0 - 58,0	500
10124BB01	12,0	6,2	2,0 - 65,0	500
10125BB01	12,0	8,2	2,0 - 63,0	500
10126BB01	12,0	9,1	2,0 - 65,0	500
10127BB01	12,0	9,6	2,0 - 50,0	500
10128BB01	14,0	8,2	2,0 - 50,0	500
10129BB01	14,0	9,5	2,0 - 50,0	500
10130BB01	14,0	12,2	2,0 - 20,0	500
10131BB01	15,0	10,4	2,0 - 50,0	500
10132BB01	15,0	11,2	2,0 - 50,0	500
10133BB01	16,0	6,2	3,0 - 30,0	500
10134BB01	16,0	10,4	2,0 - 50,0	500
10135BB01	16,0	12,4	2,0 - 50,0	500
10136BB01	20,0	5,2	2,0 - 20,0	500
10137BB01	25,2	18,2	2,0 - 20,0	500

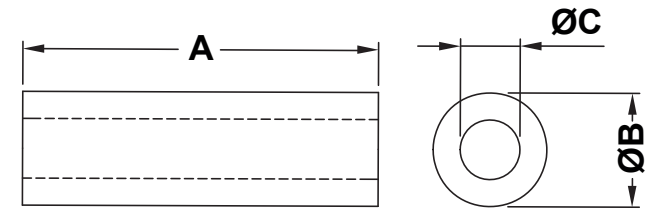

**NOTES:**  
**SCREWS NOT INCLUDED**  
**LENGTHS AVAILABLE IN INCREMENTS OF 1 mm**  
**OTHER SPECIALS LENGTHS AVAILABLE BY REQUEST**

REV.	DESCRIPTION	TITLE: ROUND P.C.B SPACER	DWG UNIT: MM
	MATERIAL: PA 6 25% GF	Modelled in RHINO 4.0	FILE: DwN:18/03/01.10XXX.0.E
	COLOUR: Black	TOLLERANCES	SHEET: 1 OF 1
	WORKING TEMPERATURE: -30°C - + 100°C	SEE ABOVE	DT: 01/03/18
FLAMMABILITY: HB (UL94)		SCALE: NTS	Chkd: Part Number: SEE TABLE