

P/N	A	B	C
15671AA0004.0	M 2	4,0	4,0
15671AA0005.0	M 2	5,0	4,0
15671AA0006.0	M 2	6,0	4,0
15671AA0008.0	M 2	8,0	4,0
15671AA0010.0	M 2	10,0	4,0
15671AA0012.0	M 2	12,0	4,0
15671AA0016.0	M 2	16,0	4,0
15671AA0020.0	M 2	20,0	4,0
15671AA0025.0	M 2	25,0	4,0
15672AA0004.0	M 2.5	4,0	5,0
15672AA0004.5	M 2.5	4,5	5,0
15672AA0005.0	M 2.5	5,0	5,0
15672AA0006.0	M 2.5	6,0	5,0
15672AA0008.0	M 2.5	8,0	5,0
15672AA0010.0	M 2.5	10,0	5,0
15672AA0012.0	M 2.5	12,0	5,0
15672AA0016.0	M 2.5	16,0	5,0
15672AA0020.0	M 2.5	20,0	5,0
15672AA0025.0	M 2.5	25,0	5,0
10311AA0004.0	M 3	4,0	6,0
10311AA0005.0	M 3	5,0	6,0
10311AA0006.0	M 3	6,0	6,0
10311AA0008.0	M 3	8,0	6,0
10311AA0010.0	M 3	10,0	6,0
10311AA0012.0	M 3	12,0	6,0
10311AA0014.0	M 3	14,0	6,0
10311AA0016.0	M 3	16,0	6,0
10311AA0018.0	M 3	18,0	6,0
10311AA0020.0	M 3	20,0	6,0
10311AA0022.0	M 3	22,0	6,0
10311AA0025.0	M 3	25,0	6,0
10311AA0028.0	M 3	28,0	6,0
10311AA0030.0	M 3	30,0	6,0
10312AA0004.0	M 4	4,0	8,0

P/N	A	B	C
10312AA0005.0	M 4	5,0	8,0
10312AA0006.0	M 4	6,0	8,0
10312AA0008.0	M 4	8,0	8,0
10312AA0010.0	M 4	10,0	8,0
10312AA0012.0	M 4	12,0	8,0
10312AA0014.0	M 4	14,0	8,0
10312AA0016.0	M 4	16,0	8,0
10312AA0018.0	M 4	18,0	8,0
10312AA0020.0	M 4	20,0	8,0
10312AA0022.0	M 4	22,0	8,0
10312AA0025.0	M 4	25,0	8,0
10312AA0028.0	M 4	28,0	8,0
10312AA0030.0	M 4	30,0	8,0
10313AA0004.0	M 5	4,0	10,0
10313AA0006.0	M 5	6,0	10,0
10313AA0008.0	M 5	8,0	10,0
10313AA0016.0	M 5	16,0	10,0
10313AA0018.0	M 5	18,0	10,0
10313AA0020.0	M 5	20,0	10,0
10313AA0022.0	M 5	22,0	10,0
10313AA0025.0	M 5	25,0	10,0
10313AA0028.0	M 5	28,0	10,0
10313AA0030.0	M 5	30,0	10,0
10313AA0035.0	M 5	35,0	10,0
10314AA0004.0	M 6	4,0	12,0
10314AA0006.0	M 6	6,0	12,0
10314AA0008.0	M 6	8,0	12,0
10314AA0016.0	M 6	16,0	12,0
10314AA0018.0	M 6	18,0	12,0
10314AA0020.0	M 6	20,0	12,0
10314AA0022.0	M 6	22,0	12,0
10314AA0025.0	M 6	25,0	12,0
10314AA0028.0	M 6	28,0	12,0
10314AA0030.0	M 6	30,0	12,0
10314AA0035.0	M 6	35,0	12,0

P/N	A	B	C
10315AA0004.0	M 8	4,0	15,0
10315AA0005.0	M 8	5,0	15,0
10315AA0006.0	M 8	6,0	15,0
10315AA0008.0	M 8	8,0	15,0
10315AA0010.0	M 8	10,0	15,0
10315AA0012.0	M 8	12,0	15,0
10315AA0014.0	M 8	14,0	15,0
10315AA0016.0	M 8	16,0	15,0
10315AA0018.0	M 8	18,0	15,0
10315AA0020.0	M 8	20,0	15,0
10315AA0023.0	M 8	23,0	15,0
10315AA0025.0	M 8	25,0	15,0
10315AA0030.0	M 8	30,0	15,0
10315AA0035.0	M 8	35,0	15,0
10316AA0004.0	M 10	4,0	20,0
10316AA0006.0	M 10	6,0	20,0
10316AA0008.0	M 10	8,0	20,0
10316AA0010.0	M 10	10,0	20,0
10316AA0012.0	M 10	12,0	20,0
10316AA0014.0	M 10	14,0	20,0
10316AA0016.0	M 10	16,0	20,0
10316AA0020.0	M 10	20,0	20,0
10316AA0025.0	M 10	25,0	20,0
10316AA0030.0	M 10	30,0	20,0
10316AA0035.0	M 10	35,0	20,0
10317AA0009.0	M 12	9,0	20,0
10317AA0010.0	M 12	10,0	20,0
10317AA0012.0	M 12	12,0	20,0
10317AA0015.0	M 12	15,0	20,0
10317AA0020.0	M 12	20,0	20,0
10317AA0025.0	M 12	25,0	20,0
10317AA0030.0	M 12	30,0	20,0
10317AA0035.0	M 12	35,0	20,0
10317AA0040.0	M 12	40,0	20,0
10317AA0045.0	M 12	45,0	20,0

DIM.	TOL.
5mm DOWN	±0.2
5~20mm	±0.3
20~40mm	±0.4
40~60mm	±0.5
60~100mm	±0.8
100mm UP	±1.0

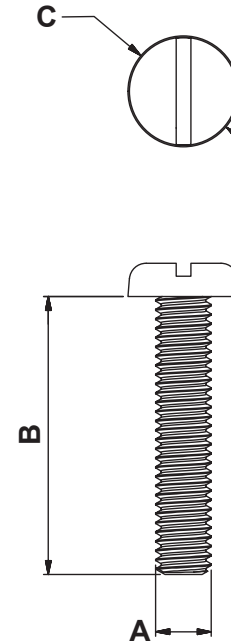

ESTIMATE ACCORDING: DIN EN ISO 1580 (DIN 85)
WORKING TEMPERATURE: -30°C ~ +100°C

REV.	DESCRIPTION	DATE	TITLE: FLAT HEAD SCREWS WITH SLIT	DWG UNIT: MM
	MATERIAL: PA 6		Modelled in RHINO 4.0	FILE:
	COLOUR: NATURAL		TOLLERANCES UNLESS NOTED	SHEET: 1 OF 1
			SEE ABOVE	SCALE: NTS
				DT: 21.05.11.XXXXX.0.E
				Part Number: SEE TABLE
				DwN: 17/01/22
				ChkD:

