

REVISIONS			
REV	DESCRIPTION	DATE	BY

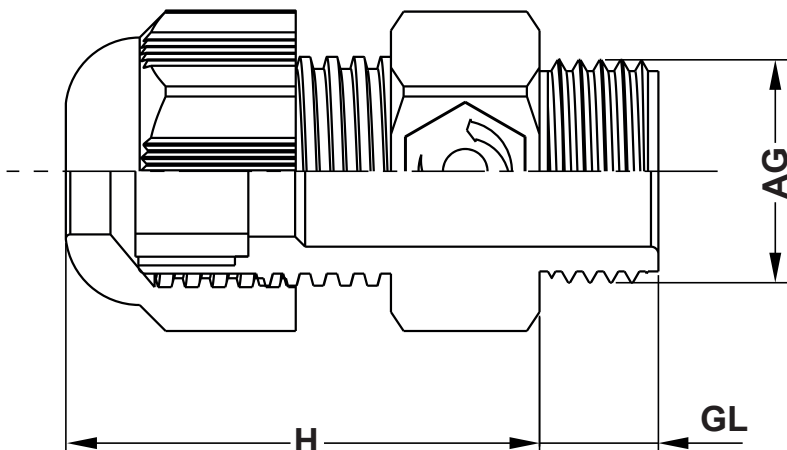

P/N RAL 7035	P/N RAL 9005	AG	H	GL	mm	CABLEØ	HOLEØ	AVERAGE AIR FLOW l/h	WATER INTRUSION mbar
13255AA117035	13255AA019005	PG 7	29,0	8,0	19,0	4,0 - 8,0	13,0	70,0	0,1
13256AA117035	13256AA019005	PG 9	33,0	8,0	19,0	4,0 - 8,0	15,5	70,0	0,1
13257AA117035	13257AA019005	PG 11	34,0	10,0	22,0	5,0 - 10,0	19,0	70,0	0,1
13258AA117035	13258AA019005	PG 13,5	34,0	10,0	24,0	4,0 - 10,0	21,0	70,0	0,1
13259AA117035	13259AA019005	PG 13,5	34,0	10,0	24,0	6,0 - 12,0	21,0	70,0	0,1

### MATERIAL

- Cap nut : Polyamide PA6 V2
- Sealing ring : TPV
- Gland body : Polyamide PA6 V2
- O-ring : NBR / EPDM
- Vent Part : Acrylic Co-Polymer on Nylon Support  
(Hydrophobic-Oleophobic)
- Connection thread : PG (DIN 40430)
- Protection class : IP68
- Temperature range : -20 °C +100 °C -30 +150 °C (short term)

				TITLE <b>PLASTIC VENTILATION GLANDS</b>	
				MATERIAL SEE ABOVE	
PART NUMBER SEE TABLE				DRAWN R.F.	
DRAWING NUMBER 19.05.06.1325X.0.E				CHECK	
COLOR SEE ABOVE				APPROVED	
SIZE A4	SCALE NTS	UNIT mm.	REV A	UNLESS OTHERWISE SPECIFIED TOLERANCE	