

DIM.	TOL.
5mm DOWN	±0.2
5~20mm	±0.3
20~40mm	±0.4
40~60mm	±0.5
60~100mm	±0.8
100mm UP	±1.0

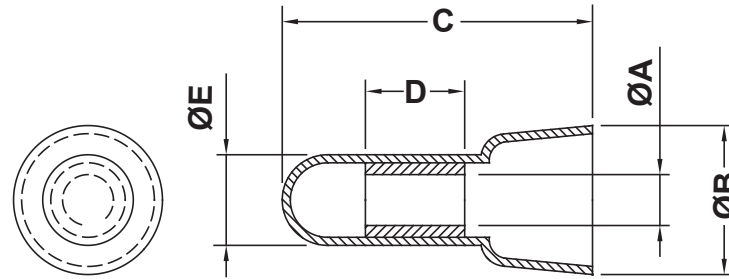

Temp Rating	Voltage	Suitable Wire A.W.G.	Suitable Wire mm <sup>2</sup>	Dimension				
				A mm	B mm	C mm	D mm	E mm
105°C	300V	16-14	2	3.2	9,5	20,1	7,0	5,7

DESCRIPTION		TITLE: CLOSE-END CONNECTOR		DWG UNIT: MM	
MATERIAL:	PA66 V2(UL94)	Modelled in RHINO 4.0		FILE:	DwN: 13.01.31.5303.E.0
COLOUR:	NATURAL	TOLLERANCES	SEE ABOVE	SHEET: 1 OF 1	DT: 31/01/13
REV.	DATE	SCALE: NTS		Part Number: 5303AA00HS	