

PRESSACAVI PG IP68 ATEX



Descrizione tecnica

Materiale del corpo: PA6

Temperatura d'esercizio: -30°C ~ +100°C

Grado di protezione: IP68

PG (DIN 40430)

Tutte le quote sono in mm

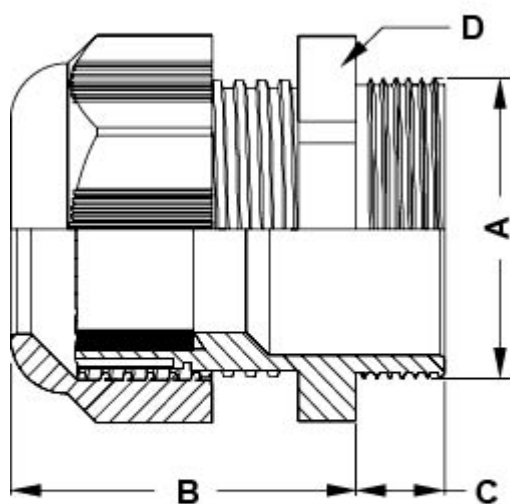

Modo di protezione / Type of protection
II 2G Ex eb IIc Gb
II 2D Ex tb IIIc Db



Codice	A	B	C	D	Colore	Ø Diametro cavo	Conf./pezzi
15066AA019005	PG 7	24,0	8,0	15,0	RAL 9005	3,0 - 6,5	200
15067AA019005	PG 9	28,0	8,0	19,0	RAL 9005	4,0 - 8,0	200
15068AA019005	PG 11	29,0	8,0	22,0	RAL 9005	5,0 - 10,0	200
15069AA019005	PG 13.5	29,0	9,0	24,0	RAL 9005	4,0 - 10,0	200
15070AA019005	PG 13.5	29,0	9,0	24,0	RAL 9005	6,0 - 12,0	200
15071AA019005	PG 16	33,0	9,0	27,0	RAL 9005	10,0 - 14,0	200
15072AA019005	PG 21	38,0	11,0	33,0	RAL 9005	13,0 - 18,0	150
15073AA019005	PG 21	38,0	11,0	33,0	RAL 9005	9,0 - 17,0	150
15074AA019005	PG 29	41,0	11,0	42,0	RAL 9005	18,0 - 25,0	100
15075AA019005	PG 36	51,0	11,0	53,0	RAL 9005	22,0 - 32,0	50
15076AA019005	PG 42	53,0	11,0	60,0	RAL 9005	30,0 - 38,0	25
15077AA019005	PG 48	55,0	14,0	65,0	RAL 9005	34,0 - 44,0	25
15079AA085015	PG 7	24,0	8,0	15,0	RAL 5015	3,0 - 6,5	200
15080AA085015	PG 9	28,0	8,0	19,0	RAL 5015	4,0 - 8,0	200
15081AA085015	PG 11	29,0	8,0	22,0	RAL 5015	5,0 - 10,0	200
15082AA085015	PG 13.5	29,0	9,0	24,0	RAL 5015	4,0 - 10,0	200
15083AA085015	PG 13.5	29,0	9,0	24,0	RAL 5015	6,0 - 12,0	200
15084AA085015	PG 16	33,0	9,0	27,0	RAL 5015	10,0 - 14,0	200
15085AA085015	PG 21	38,0	11,0	33,0	RAL 5015	13,0 - 18,0	150
15086AA085015	PG 21	38,0	11,0	33,0	RAL 5015	9,0 - 17,0	150
15087AA085015	PG 29	41,0	11,0	42,0	RAL 5015	18,0 - 25,0	100
15088AA085015	PG 36	51,0	11,0	53,0	RAL 5015	22,0 - 32,0	50
15089AA085015	PG 42	53,0	11,0	60,0	RAL 5015	30,0 - 38,0	25
15090AA085015	PG 48	55,0	14,0	65,0	RAL 5015	34,0 - 44,0	25