

## DISTANZIATORI METRICI FILETTATI ESAGONALI M4



### Descrizione tecnica

**Materiale:** PA 6, 25%GV

**Colore:** nero

**Autoestinguenza:** HB (UL 94)

**Temperatura esercizio:** -30°C ~ +110°C

Tutte le quote sono in mm

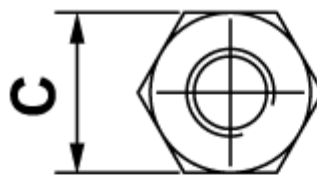

**Type 1**

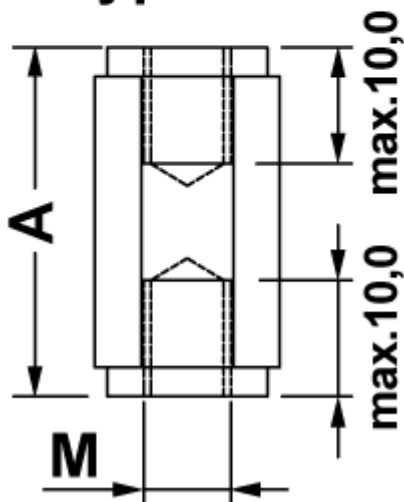

**Type 2**

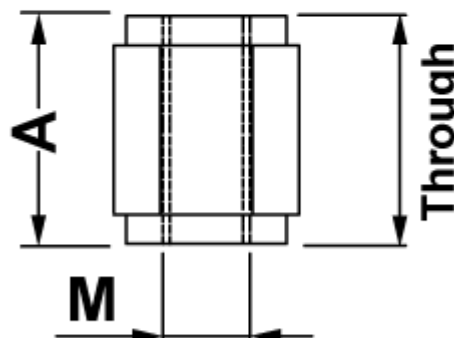

Codice	A	M	C	Type	Conf./pezzi
8161BB0105.0	5,0	M4	7,0	1	500
8161BB0106.0	6,0	M4	7,0	1	500
8161BB0107.0	7,0	M4	7,0	1	500
8161BB0108.0	8,0	M4	7,0	1	500
8161BB0109.0	9,0	M4	7,0	1	500
8161BB0110.0	10,0	M4	7,0	1	500
8161BB0111.0	11,0	M4	7,0	1	500
8161BB0112.0	12,0	M4	7,0	1	500
8161BB0113.0	13,0	M4	7,0	1	500
8161BB0114.0	14,0	M4	7,0	1	500
8161BB0115.0	15,0	M4	7,0	1	500
8161BB0116.0	16,0	M4	7,0	1	500
8161BB0117.0	17,0	M4	7,0	1	500
8161BB0118.0	18,0	M4	7,0	1	500
8161BB0119.0	19,0	M4	7,0	1	500
8161BB0120.0	20,0	M4	7,0	1	500
8161BB0121.0	21,0	M4	7,0	2	500
8161BB0122.0	22,0	M4	7,0	2	500
8161BB0123.0	23,0	M4	7,0	2	500
8161BB0124.0	24,0	M4	7,0	2	500
8161BB0125.0	25,0	M4	7,0	2	500
8161BB0126.0	26,0	M4	7,0	2	500
8161BB0127.0	27,0	M4	7,0	2	500
8161BB0128.0	28,0	M4	7,0	2	500
8161BB0129.0	29,0	M4	7,0	2	500
8161BB0130.0	30,0	M4	7,0	2	500
8161BB0131.0	31,0	M4	7,0	2	500
8161BB0132.0	32,0	M4	7,0	2	500
8161BB0133.0	33,0	M4	7,0	2	500
8161BB0134.0	34,0	M4	7,0	2	500
8161BB0135.0	35,0	M4	7,0	2	500

Codice	A	M	C	Type	Conf./pezzi
8161BB0136.0	36,0	M4	7,0	2	500
8161BB0137.0	37,0	M4	7,0	2	500
8161BB0138.0	38,0	M4	7,0	2	500
8161BB0139.0	39,0	M4	7,0	2	500
8161BB0140.0	40,0	M4	7,0	2	500
8161BB0141.0	41,0	M4	7,0	2	500
8161BB0142.0	42,0	M4	7,0	2	500
8161BB0143.0	43,0	M4	7,0	2	500
8161BB0144.0	44,0	M4	7,0	2	500
8161BB0145.0	45,0	M4	7,0	2	500
8161BB0146.0	46,0	M4	7,0	2	500
8161BB0147.0	47,0	M4	7,0	2	500
8161BB0148.0	48,0	M4	7,0	2	500
8161BB0149.0	49,0	M4	7,0	2	500
8161BB0150.0	50,0	M4	7,0	2	500
8161BB0151.0	51,0	M4	7,0	2	500
8161BB0152.0	52,0	M4	7,0	2	500
8161BB0153.0	53,0	M4	7,0	2	500
8161BB0154.0	54,0	M4	7,0	2	500
8161BB0155.0	55,0	M4	7,0	2	500
8161BB0156.0	56,0	M4	7,0	2	500
8161BB0157.0	57,0	M4	7,0	2	500
8161BB0158.0	58,0	M4	7,0	2	500
8161BB0159.0	59,0	M4	7,0	2	500
8161BB0160.0	60,0	M4	7,0	2	500
8161BB0161.0	61,0	M4	7,0	2	500
8161BB0162.0	62,0	M4	7,0	2	500
8161BB0163.0	63,0	M4	7,0	2	500
8161BB0164.0	64,0	M4	7,0	2	500
8161BB0165.0	65,0	M4	7,0	2	500
8161BB0166.0	66,0	M4	7,0	2	500

Codice	A	M	C	Type	Conf./pezzi
8161BB0167.0	67,0	M4	7,0	2	500
8161BB0168.0	68,0	M4	7,0	2	500