

TORNILLO CABEZA RANURA EN CRUZ DIN 34812



Descripción Técnica

Material: PA6

Color: Natural

Norma de referencia: DIN 34812

Temperatura de trabajo: -30°C ~ +100°C

Todas las medidas están indicadas en mm

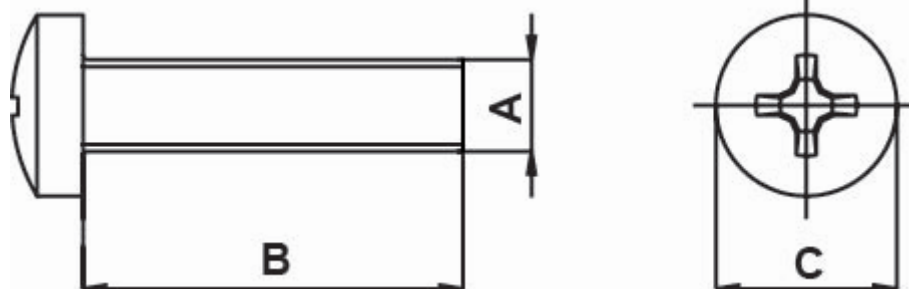

Codigo	A	B	C	Conf./piezas
10320AA0004.0	M 3	4,0	6,0	1.000
10320AA0005.0	M 3	5,0	6,0	1.000
10320AA0006.0	M 3	6,0	6,0	1.000
10320AA0008.0	M 3	8,0	6,0	1.000
10320AA0010.0	M 3	10,0	6,0	1.000
10320AA0012.0	M 3	12,0	6,0	1.000
10320AA0014.0	M 3	14,0	6,0	1.000
10320AA0016.0	M 3	16,0	6,0	1.000
10320AA0018.0	M 3	18,0	6,0	1.000
10320AA0020.0	M 3	20,0	6,0	1.000
10320AA0022.0	M 3	22,0	6,0	1.000
10320AA0025.0	M 3	25,0	6,0	1.000

Codigo	A	B	C	Conf./piezas
10320AA0028.0	M 3	28,0	6,0	1.000
10320AA0030.0	M 3	30,0	6,0	1.000
10321AA0004.0	M 4	4,0	8,0	1.000
10321AA0005.0	M 4	5,0	8,0	1.000
10321AA0006.0	M 4	6,0	8,0	1.000
10321AA0008.0	M 4	8,0	8,0	1.000
10321AA0010.0	M 4	10,0	8,0	1.000
10321AA0012.0	M 4	12,0	8,0	1.000
10321AA0014.0	M 4	14,0	8,0	1.000
10321AA0016.0	M 4	16,0	8,0	1.000
10321AA0018.0	M 4	18,0	8,0	1.000
10321AA0020.0	M 4	20,0	8,0	1.000
10321AA0023.0	M 4	23,0	8,0	1.000
10321AA0025.0	M 4	25,0	8,0	1.000
10321AA0028.0	M 4	28,0	8,0	1.000
10321AA0030.0	M 4	30,0	8,0	1.000
10322AA0004.0	M 5	4,0	10,0	1.000
10322AA0006.0	M 5	6,0	10,0	1.000
10322AA0008.0	M 5	8,0	10,0	1.000
10322AA0010.0	M 5	10,0	10,0	1.000
10322AA0012.0	M 5	12,0	10,0	1.000
10322AA0014.0	M 5	14,0	10,0	1.000
10322AA0016.0	M 5	16,0	10,0	1.000
10322AA0020.0	M 5	20,0	10,0	1.000
10322AA0025.0	M 5	25,0	10,0	1.000
10322AA0030.0	M 5	30,0	10,0	1.000
10322AA0035.0	M 5	35,0	10,0	1.000
10323AA0004.0	M 6	4,0	12,0	1.000
10323AA0006.0	M 6	6,0	12,0	1.000
10323AA0008.0	M 6	8,0	12,0	1.000
10323AA0010.0	M 6	10,0	12,0	1.000

Codigo	A	B	C	Conf./piezas
10323AA0012.0	M 6	12,0	12,0	1.000
10323AA0014.0	M 6	14,0	12,0	1.000
10323AA0016.0	M 6	16,0	12,0	1.000
10323AA0020.0	M 6	20,0	12,0	1.000
10323AA0025.0	M 6	25,0	12,0	1.000
10323AA0030.0	M 6	30,0	12,0	1.000
10323AA0035.0	M 6	35,0	12,0	1.000
10324AA0004.0	M 8	4,0	16,0	1.000
10324AA0005.0	M 8	5,0	16,0	1.000
10324AA0006.0	M 8	6,0	16,0	1.000
10324AA0008.0	M 8	8,0	16,0	1.000
10324AA0010.0	M 8	10,0	16,0	1.000
10324AA0012.0	M 8	12,0	16,0	1.000
10324AA0015.0	M 8	15,0	16,0	1.000
10324AA0016.0	M 8	16,0	16,0	1.000
10324AA0018.0	M 8	18,0	16,0	1.000
10324AA0020.0	M 8	20,0	16,0	1.000
10324AA0023.0	M 8	23,0	16,0	1.000
10324AA0025.0	M 8	25,0	16,0	1.000
10324AA0030.0	M 8	30,0	16,0	1.000
10324AA0035.0	M 8	35,0	16,0	1.000
15695AA0004.0	M 2	4,0	4,0	1.000
15695AA0005.0	M 2	5,0	4,0	1.000
15695AA0006.0	M 2	6,0	4,0	1.000
15695AA0008.0	M 2	8,0	4,0	1.000
15695AA0010.0	M 2	10,0	4,0	1.000
15695AA0012.0	M 2	12,0	4,0	1.000
15695AA0016.0	M 2	16,0	4,0	1.000
15695AA0020.0	M 2	20,0	4,0	1.000
15695AA0025.0	M 2	25,0	4,0	1.000
15696AA0004.0	M 2.5	4,0	5,0	1.000

Codigo	A	B	C	Conf./piezas
15696AA0004.5	M 2.5	4,5	5,0	1.000
15696AA0005.0	M 2.5	5,0	5,0	1.000
15696AA0006.0	M 2.5	6,0	5,0	1.000
15696AA0008.0	M 2.5	8,0	5,0	1.000
15696AA0010.0	M 2.5	10,0	5,0	1.000
15696AA0012.0	M 2.5	12,0	5,0	1.000
15696AA0016.0	M 2.5	16,0	5,0	1.000
15696AA0020.0	M 2.5	20,0	5,0	1.000
15696AA0025.0	M 2.5	25,0	5,0	1.000