

# REVERSE LOCKING P.C.B. SPACERS



## Technical description

**Material:** PA 6.6

**Colour:** Black

**UL Flammability:** V2 (UL 94)

**Operating temperature:** -35°C ~ +130°C

All dimensions are in mm.

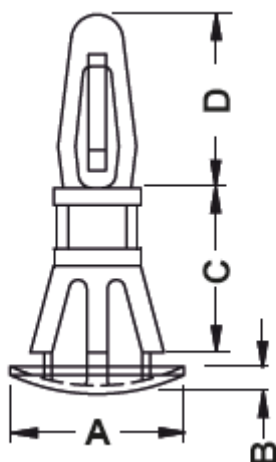

| Code          | A   | B   | C    | D   | Top Hole | Top thickness | Bottom hole | Bottom thickness | MOQ-Pcs |
|---------------|-----|-----|------|-----|----------|---------------|-------------|------------------|---------|
| 10006AA0104.0 | 9,0 | 1,5 | 4,0  | 9,8 | Ø 4,0    | 0,6           | Ø 5,0       | 1,0              | 500     |
| 10006AA0105.0 | 9,0 | 1,5 | 5,0  | 9,8 | Ø 4,0    | 0,6           | Ø 5,0       | 1,0              | 500     |
| 10006AA0106.0 | 9,0 | 1,5 | 6,0  | 9,8 | Ø 4,0    | 0,6           | Ø 5,0       | 1,0              | 500     |
| 10006AA0107.0 | 9,0 | 1,5 | 7,0  | 9,8 | Ø 4,0    | 0,6           | Ø 5,0       | 1,0              | 500     |
| 10006AA0108.0 | 9,0 | 1,5 | 8,0  | 9,8 | Ø 4,0    | 0,6           | Ø 5,0       | 1,0              | 500     |
| 10006AA0109.0 | 9,0 | 1,5 | 9,0  | 9,8 | Ø 4,0    | 0,6           | Ø 5,0       | 1,0              | 500     |
| 10006AA0110.0 | 9,0 | 1,5 | 10,0 | 9,8 | Ø 4,0    | 0,6           | Ø 5,0       | 1,0              | 500     |

| Code          | A   | B   | C    | D   | Top Hole | Top thickness | Bottom hole | Bottom thickness | MOQ-Pcs |
|---------------|-----|-----|------|-----|----------|---------------|-------------|------------------|---------|
| 10006AA0111.0 | 9,0 | 1,5 | 11,0 | 9,8 | Ø 4,0    | 0,6           | Ø 5,0       | 1,0              | 500     |
| 10006AA0112.0 | 9,0 | 1,5 | 12,0 | 9,8 | Ø 4,0    | 0,6           | Ø 5,0       | 1,0              | 500     |
| 10006AA0113.0 | 9,0 | 1,5 | 13,0 | 9,8 | Ø 4,0    | 0,6           | Ø 5,0       | 1,0              | 500     |
| 10006AA0114.0 | 9,0 | 1,5 | 14,0 | 9,8 | Ø 4,0    | 0,6           | Ø 5,0       | 1,0              | 500     |
| 10006AA0115.0 | 9,0 | 1,5 | 15,0 | 9,8 | Ø 4,0    | 0,6           | Ø 5,0       | 1,0              | 500     |
| 10006AA0116.0 | 9,0 | 1,5 | 16,0 | 9,8 | Ø 4,0    | 0,6           | Ø 5,0       | 1,0              | 500     |
| 10006AA0117.0 | 9,0 | 1,5 | 17,0 | 9,8 | Ø 4,0    | 0,6           | Ø 5,0       | 1,0              | 500     |
| 10006AA0118.0 | 9,0 | 1,5 | 18,0 | 9,8 | Ø 4,0    | 0,6           | Ø 5,0       | 1,0              | 500     |
| 10006AA0119.0 | 9,0 | 1,5 | 19,0 | 9,8 | Ø 4,0    | 0,6           | Ø 5,0       | 1,0              | 500     |
| 10006AA0120.0 | 9,0 | 1,5 | 20,0 | 9,8 | Ø 4,0    | 0,6           | Ø 5,0       | 1,0              | 500     |
| 10006AA0121.0 | 9,0 | 1,5 | 21,0 | 9,8 | Ø 4,0    | 0,6           | Ø 5,0       | 1,0              | 500     |
| 10006AA0122.0 | 9,0 | 1,5 | 22,0 | 9,8 | Ø 4,0    | 0,6           | Ø 5,0       | 1,0              | 500     |
| 10006AA0123.0 | 9,0 | 1,5 | 23,0 | 9,8 | Ø 4,0    | 0,6           | Ø 5,0       | 1,0              | 500     |
| 10006AA0124.0 | 9,0 | 1,5 | 24,0 | 9,8 | Ø 4,0    | 0,6           | Ø 5,0       | 1,0              | 500     |
| 10006AA0125.0 | 9,0 | 1,5 | 25,0 | 9,8 | Ø 4,0    | 0,6           | Ø 5,0       | 1,0              | 500     |
| 10006AA0126.0 | 9,0 | 1,5 | 26,0 | 9,8 | Ø 4,0    | 0,6           | Ø 5,0       | 1,0              | 500     |
| 10006AA0127.0 | 9,0 | 1,5 | 27,0 | 9,8 | Ø 4,0    | 0,6           | Ø 5,0       | 1,0              | 500     |
| 10006AA0128.0 | 9,0 | 1,5 | 28,0 | 9,8 | Ø 4,0    | 0,6           | Ø 5,0       | 1,0              | 500     |
| 10006AA0129.0 | 9,0 | 1,5 | 29,0 | 9,8 | Ø 4,0    | 0,6           | Ø 5,0       | 1,0              | 500     |
| 10006AA0130.0 | 9,0 | 1,5 | 30,0 | 9,8 | Ø 4,0    | 0,6           | Ø 5,0       | 1,0              | 500     |
| 10006AA0131.0 | 9,0 | 1,5 | 31,0 | 9,8 | Ø 4,0    | 0,6           | Ø 5,0       | 1,0              | 500     |
| 10006AA0132.0 | 9,0 | 1,5 | 32,0 | 9,8 | Ø 4,0    | 0,6           | Ø 5,0       | 1,0              | 500     |
| 10006AA0133.0 | 9,0 | 1,5 | 33,0 | 9,8 | Ø 4,0    | 0,6           | Ø 5,0       | 1,0              | 500     |
| 10006AA0134.0 | 9,0 | 1,5 | 34,0 | 9,8 | Ø 4,0    | 0,6           | Ø 5,0       | 1,0              | 500     |
| 10006AA0135.0 | 9,0 | 1,5 | 35,0 | 9,8 | Ø 4,0    | 0,6           | Ø 5,0       | 1,0              | 500     |
| 10006AA0136.0 | 9,0 | 1,5 | 36,0 | 9,8 | Ø 4,0    | 0,6           | Ø 5,0       | 1,0              | 500     |