

PAN HEAD SCREW WITH HEXAGONAL SOCKET DIN 912



Technical description

Material: PA 6

Colour : Natural

Estimate according: DIN 912

Operating temperature:

-30° C. ~ + max 100° C

All dimensions are in mm.

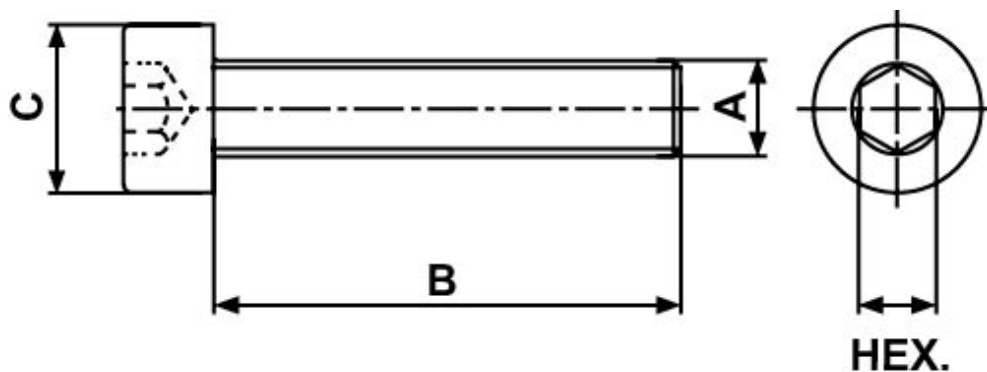

Code	A	B	C	HEX	MOQ-Pcs
10341AA0004.0	M 3	4,0	5,5	2,5	1.000
10341AA0006.0	M 3	6,0	5,5	2,5	1.000
10341AA0008.0	M 3	8,0	5,5	2,5	1.000
10341AA0010.0	M 3	10,0	5,5	2,5	1.000
10341AA0012.0	M 3	12,0	5,5	2,5	1.000
10341AA0014.0	M 3	14,0	5,5	2,5	1.000
10341AA0016.0	M 3	16,0	5,5	2,5	1.000

Code	A	B	C	HEX	MOQ-Pcs
10341AA0018.0	M 3	18,0	5,5	2,5	1.000
10341AA0020.0	M 3	20,0	5,5	2,5	1.000
10341AA0022.0	M 3	22,0	5,5	2,5	1.000
10341AA0025.0	M 3	25,0	5,5	2,5	1.000
10342AA0004.0	M 4	4,0	7,0	3,0	1.000
10342AA0006.0	M 4	6,0	7,0	3,0	1.000
10342AA0008.0	M 4	8,0	7,0	3,0	1.000
10342AA0010.0	M 4	10,0	7,0	3,0	1.000
10342AA0012.0	M 4	12,0	7,0	3,0	1.000
10342AA0014.0	M 4	14,0	7,0	3,0	1.000
10342AA0016.0	M 4	16,0	7,0	3,0	1.000
10342AA0018.0	M 4	18,0	7,0	3,0	1.000
10342AA0020.0	M 4	20,0	7,0	3,0	1.000
10342AA0023.0	M 4	23,0	7,0	3,0	1.000
10342AA0025.0	M 4	25,0	7,0	3,0	1.000
10343AA0004.0	M 5	4,0	8,5	4,0	1.000
10343AA0006.0	M 5	6,0	8,5	4,0	1.000
10343AA0008.0	M 5	8,0	8,5	4,0	1.000
10343AA0010.0	M 5	10,0	8,5	4,0	1.000
10343AA0012.0	M 5	12,0	8,5	4,0	1.000
10343AA0016.0	M 5	16,0	8,5	4,0	1.000
10343AA0020.0	M 5	20,0	8,5	4,0	1.000
10343AA0025.0	M 5	25,0	8,5	4,0	1.000
10343AA0030.0	M 5	30,0	8,5	4,0	1.000
10343AA0035.0	M 5	35,0	8,5	4,0	1.000
10343AA0040.0	M 5	40,0	8,5	4,0	1.000
10344AA0005.0	M 6	5,0	10,0	5,0	1.000
10344AA0006.0	M 6	6,0	10,0	5,0	1.000
10344AA0008.0	M 6	8,0	10,0	5,0	1.000
10344AA0010.0	M 6	10,0	10,0	5,0	1.000
10344AA0012.0	M 6	12,0	10,0	5,0	1.000

Code	A	B	C	HEX	MOQ-Pcs
10344AA0016.0	M 6	16,0	10,0	5,0	1.000
10344AA0020.0	M 6	20,0	10,0	5,0	1.000
10344AA0025.0	M 6	25,0	10,0	5,0	1.000
10344AA0030.0	M 6	30,0	10,0	5,0	1.000
10344AA0035.0	M 6	35,0	10,0	5,0	1.000
10344AA0040.0	M 6	40,0	10,0	5,0	1.000
10345AA0005.0	M 8	5,0	13,0	6,0	1.000
10345AA0006.0	M 8	6,0	13,0	6,0	1.000
10345AA0008.0	M 8	8,0	13,0	6,0	1.000
10345AA0010.0	M 8	10,0	13,0	6,0	1.000
10345AA0012.0	M 8	12,0	13,0	6,0	1.000
10345AA0016.0	M 8	16,0	13,0	6,0	1.000
10345AA0018.0	M 8	18,0	13,0	6,0	1.000
10345AA0020.0	M 8	20,0	13,0	6,0	1.000
10345AA0023.0	M 8	23,0	13,0	6,0	1.000
10345AA0025.0	M 8	25,0	13,0	6,0	1.000
10345AA0030.0	M 8	30,0	13,0	6,0	1.000
10346AA0006.0	M10	6,0	16,0	8,0	1.000
10346AA0008.0	M10	8,0	16,0	8,0	1.000
10346AA0010.0	M10	10,0	16,0	8,0	1.000
10346AA0012.0	M10	12,0	16,0	8,0	1.000
10346AA0014.0	M10	14,0	16,0	8,0	1.000
10346AA0016.0	M10	16,0	16,0	8,0	1.000
10346AA0020.0	M10	20,0	16,0	8,0	1.000
10346AA0025.0	M10	25,0	16,0	8,0	1.000
10346AA0030.0	M10	30,0	16,0	8,0	1.000
10346AA0035.0	M10	35,0	16,0	8,0	1.000
10346AA0040.0	M10	40,0	16,0	8,0	1.000
10347AA0010.0	M12	10,0	18,0	10,0	1.000
10347AA0015.0	M12	15,0	18,0	10,0	1.000
10347AA0020.0	M12	20,0	18,0	10,0	1.000

Code	A	B	C	HEX	MOQ-Pcs
10347AA0025.0	M12	25,0	18,0	10,0	1.000
10347AA0030.0	M12	30,0	18,0	10,0	1.000
10347AA0035.0	M12	35,0	18,0	10,0	1.000
10347AA0040.0	M12	40,0	18,0	10,0	1.000
10347AA0045.0	M12	45,0	18,0	10,0	1.000
10347AA0050.0	M12	50,0	18,0	10,0	1.000