

# KNURLED THUMB SCREW STEEL M6



## Technical description

**Material:** STEEL

**Surface:** zinkt plated A2k

**on special request in Aluminium and stainless steel**

**DIN 464**

**All dimensions are in mm**

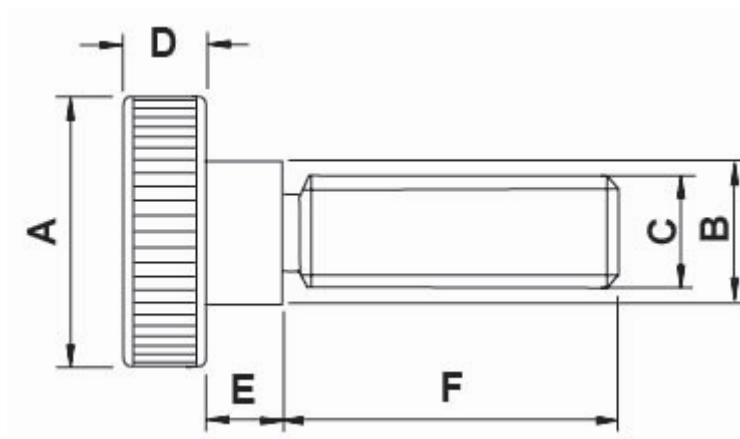

Code	A	B	C	D	E	F	MOQ-Pcs
10873MC9408.0	24,0	12,0	M6	5,0	10,0	8,0	100
10873MC9410.0	24,0	12,0	M6	5,0	10,0	10,0	100
10873MC9412.0	24,0	12,0	M6	5,0	10,0	12,0	100
10873MC9416.0	24,0	12,0	M6	5,0	10,0	16,0	100
10873MC9418.0	24,0	12,0	M6	5,0	10,0	18,0	100
10873MC9420.0	24,0	12,0	M6	5,0	10,0	20,0	100
10873MC9425.0	24,0	12,0	M6	5,0	10,0	25,0	100
10873MC9430.0	24,0	12,0	M6	5,0	10,0	30,0	100