

KNURLED THUMB SCREW STEEL M4



Technical description

Material: STEEL

Surface: zinkt plated A2k

on special request in Aluminium and stainless steel

DIN 464

All dimensions are in mm

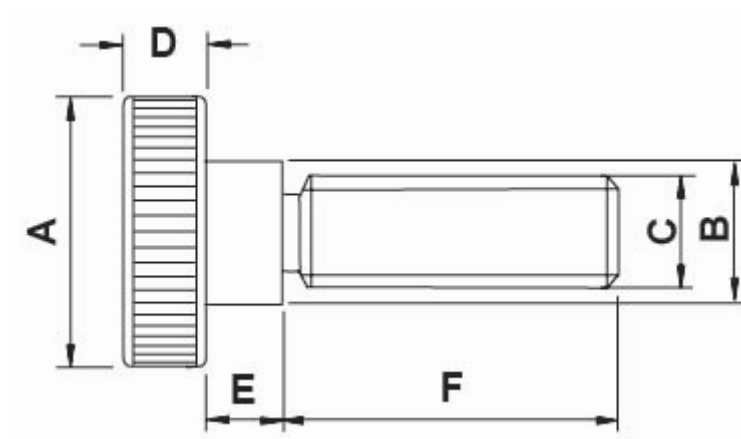

Code	A	B	C	D	E	F	MOQ-Pcs
10871MC9405.0	16,0	8,0	M4	3,5	6,0	5,0	100
10871MC9406.0	16,0	8,0	M4	3,5	6,0	6,0	100
10871MC9408.0	16,0	8,0	M4	3,5	6,0	8,0	100
10871MC9410.0	16,0	8,0	M4	3,5	6,0	10,0	100
10871MC9412.0	16,0	8,0	M4	3,5	6,0	12,0	100
10871MC9416.0	16,0	8,0	M4	3,5	6,0	16,0	100
10871MC9418.0	16,0	8,0	M4	3,5	6,0	18,0	100
10871MC9420.0	16,0	8,0	M4	3,5	6,0	20,0	100
10871MC9425.0	16,0	8,0	M4	3,5	6,0	25,0	100

Code	A	B	C	D	E	F	MOQ-Pcs
10871MC9430.0	16,0	8,0	M4	3,5	6,0	30,0	100