

FLAT HEAD SCREW WITH SLIT

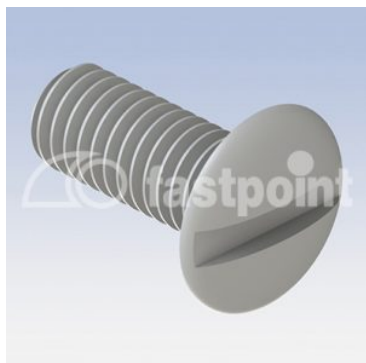

Technical description

Material: PA 6

Colour : Natural

Operating temperature:

-30° C ~ + max. 100° C

All dimensions are in mm.

Intermediates thread lengths upon request

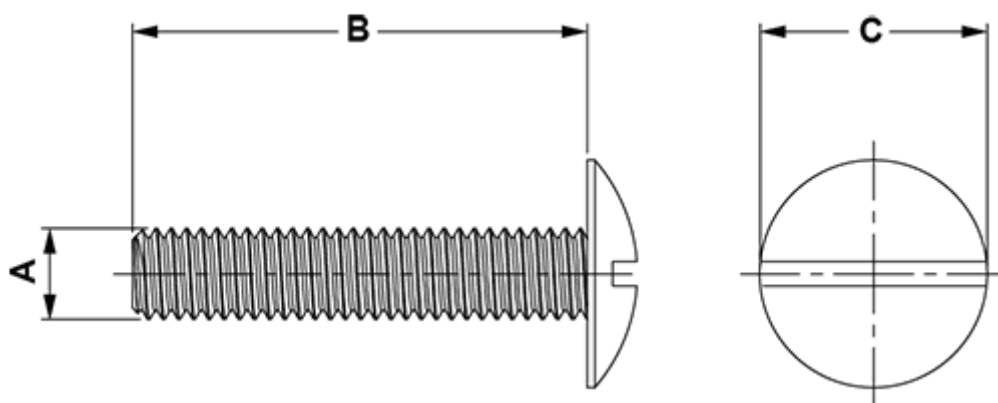

Code	A	B	C	MOQ-Pcs
10327AA0004.0	M 3	4,0	9,0	1.000
10327AA0005.0	M 3	5,0	9,0	1.000
10327AA0006.0	M 3	6,0	9,0	1.000
10327AA0008.0	M 3	8,0	9,0	1.000
10327AA0010.0	M 3	10,0	9,0	1.000
10327AA0012.0	M 3	12,0	9,0	1.000

Code	A	B	C	MOQ-Pcs
10327AA0014.0	M 3	14,0	9,0	1.000
10327AA0016.0	M 3	16,0	9,0	1.000
10327AA0018.0	M 3	18,0	9,0	1.000
10327AA0020.0	M 3	20,0	9,0	1.000
10327AA0022.0	M 3	22,0	9,0	1.000
10327AA0025.0	M 3	25,0	9,0	1.000
10327AA0028.0	M 3	28,0	9,0	1.000
10327AA0030.0	M 3	30,0	9,0	1.000
10328AA0004.0	M 4	4,0	9,0	1.000
10328AA0005.0	M 4	5,0	9,0	1.000
10328AA0006.0	M 4	6,0	9,0	1.000
10328AA0008.0	M 4	8,0	9,0	1.000
10328AA0010.0	M 4	10,0	9,0	1.000
10328AA0012.0	M 4	12,0	9,0	1.000
10328AA0014.0	M 4	14,0	9,0	1.000
10328AA0016.0	M 4	16,0	9,0	1.000
10328AA0018.0	M 4	18,0	9,0	1.000
10328AA0020.0	M 4	20,0	9,0	1.000
10328AA0023.0	M 4	23,0	9,0	1.000
10328AA0025.0	M 4	25,0	9,0	1.000
10328AA0028.0	M 4	28,0	9,0	1.000
10328AA0030.0	M 4	30,0	9,0	1.000
10329AA0004.0	M 5	4,0	11,0	1.000
10329AA0006.0	M 5	6,0	11,0	1.000
10329AA0008.0	M 5	8,0	11,0	1.000
10329AA0010.0	M 5	10,0	11,0	1.000
10329AA0012.0	M 5	12,0	11,0	1.000
10329AA0014.0	M 5	14,0	11,0	1.000
10329AA0016.0	M 5	16,0	11,0	1.000
10329AA0018.0	M 5	18,0	11,0	1.000
10329AA0020.0	M 5	20,0	11,0	1.000

Code	A	B	C	MOQ-Pcs
10329AA0025.0	M 5	25,0	11,0	1.000
10329AA0030.0	M 5	30,0	11,0	1.000
10330AA0005.0	M 6	5,0	14,0	1.000
10330AA0006.0	M 6	6,0	14,0	1.000
10330AA0008.0	M 6	8,0	14,0	1.000
10330AA0010.0	M 6	10,0	14,0	1.000
10330AA0012.0	M 6	12,0	14,0	1.000
10330AA0014.0	M 6	14,0	14,0	1.000
10330AA0016.0	M 6	16,0	14,0	1.000
10330AA0020.0	M 6	20,0	14,0	1.000
10330AA0025.0	M 6	25,0	14,0	1.000
10330AA0030.0	M 6	30,0	14,0	1.000