

RÄNDELSCHRAUBE STAHL M3

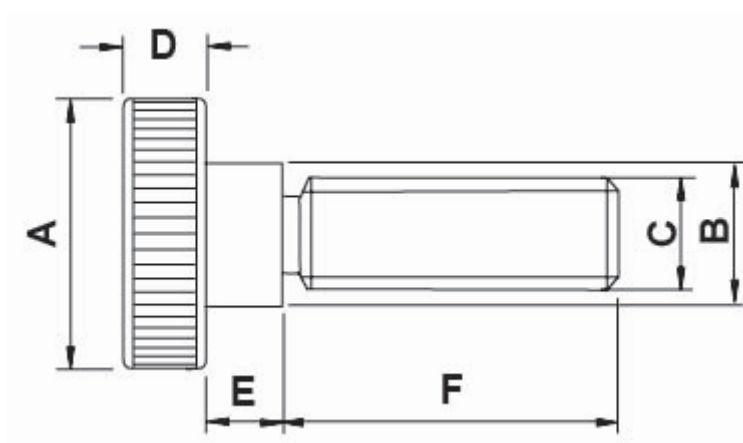

Technische Beschreibung

Material: Stahl **Oberfläche:** verzinkt A2K **Auf Anfrage auch in Aluminium und Edelstahl DIN 464** Alle Maße sind in mm.



Artikel	A	B	C	D	E	F	VPE-Stckz.
10870MC9404.0	12,0	6,0	M3	2,5	5,0	4,0	100
10870MC9405.0	12,0	6,0	M3	2,5	5,0	5,0	100
10870MC9406.0	12,0	6,0	M3	2,5	5,0	6,0	100
10870MC9408.0	12,0	6,0	M3	2,5	5,0	8,0	100
10870MC9410.0	12,0	6,0	M3	2,5	5,0	10,0	100
10870MC9412.0	12,0	6,0	M3	2,5	5,0	12,0	100
10870MC9416.0	12,0	6,0	M3	2,5	5,0	16,0	100
10870MC9420.0	12,0	6,0	M3	2,5	5,0	20,0	100
10870MC9425.0	12,0	6,0	M3	2,5	5,0	25,0	100
10870MC9430.0	12,0	6,0	M3	2,5	5,0	30,0	100
10870MC9435.0	12,0	6,0	M3	2,5	5,0	35,0	100
10870MC9440.0	12,0	6,0	M3	2,5	5,0	40,0	100